

## POST SUPPORTED WALKWAY CANOPIES



### AN ALL-EXTRUDED WALKWAY CANOPY SOLUTION

Post supported walkway covers by Mapes Architectural Canopies provide a pre-engineered economical alternative for both free standing and wall mounted applications. The all-extruded Super Lumideck is designed to meet local building codes for snow and wind load. Free spans up to 20', dependent upon local codes and load requirements, can provide a high strength protective cover with a minimum of support structure.

For more details, please visit [mapes.com](http://mapes.com)

# POST SUPPORTED WALKWAY CANOPIES

## TECHNICAL DATA

All-extruded Aluminum (T6 – 6063)

Fascia .125"

Decking .078"

Deflection rating L/180

Note: Engineered stamped calcs  
available in all 50 states

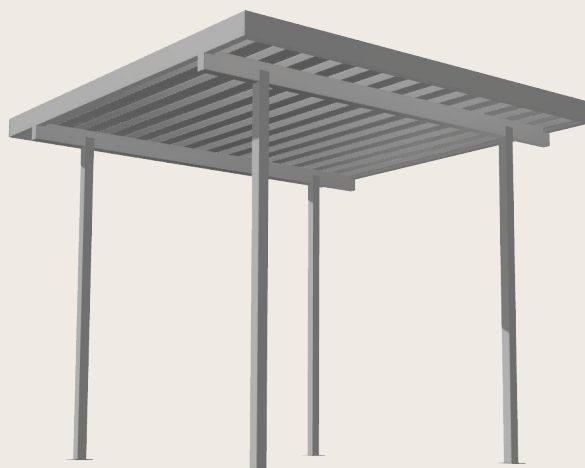

### FEATURES

- Pre-engineered
- High Load Capacity
- Long Span
- All Aluminum Canopy
- All-extruded Canopy
- Custom Colors
- Internal Drainage

### APPLICATIONS

- Walkway Covers
- Retail Branding
- Office Buildings
- Bus Shelters
- Equipment Protection
- ADA Access Doors
- Schools

### DECK OPTIONS

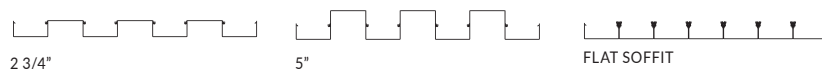

### FASCIA OPTIONS

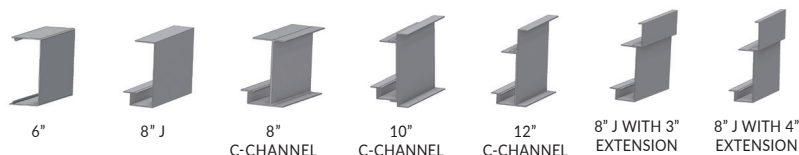

### CANOPY DETAILS

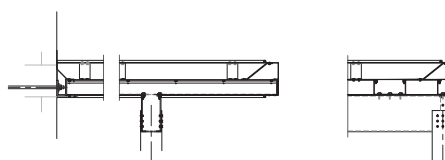

WALL MOUNTED STYLE

### POST ATTACHMENT DETAILS

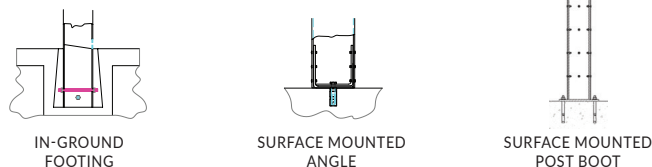

### SECTION DETAIL

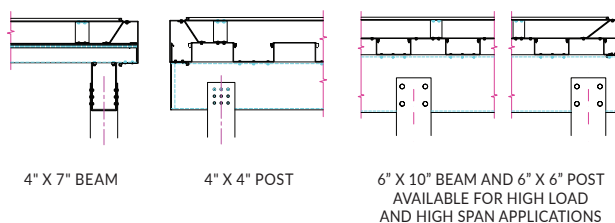

4" X 7" BEAM

4" X 4" POST

6" X 10" BEAM AND 6" X 6" POST  
AVAILABLE FOR HIGH LOAD  
AND HIGH SPAN APPLICATIONS

**MAPES ARCHITECTURAL CANOPIES**

7748 North 56th Street, Lincoln, NE 68514 Phone: 888-273-1132 Fax: 877-455-6572 [mapes.com](http://mapes.com)